



simple steps for Getting Your Project Started

Thinking about remodeling a living area, such as a kitchen or bath, can be overwhelming, especially if you think of it as one big project. Instead, approach your project in small pieces. We are here to guide you every step of the way. The first step in the process is creating a *very rough* map of your current space. Simply follow these steps:

1. Gather your tools—Use the grid paper and guide on the inside of this brochure, a pencil and eraser, and a measuring tape.
2. Measure your room. Start in one corner and measure the wall. **Record all measurements in inches.** Draw each wall on the graph paper and write in the inches. 
3. Draw in doors and windows. Indicate which way they swing open. When measuring windows and doors, please include the trim as part of your measurement. For instance, a 3" trim on one side of the window, plus a 30" window, plus a 3" trim on the other side of the window, equals a 36" window. Draw in any other breaks in the walls.
4. After you have measured and recorded each wall and its measurement **in inches** on your grid, measure and roughly draw in each item against each wall on the grid. For instance, there may be an appliance or a grouping of cabinets.
5. Write down the ceiling height of your room.
6. Make a notation of all existing appliance dimensions.

Bring your map into our **Woburn showroom** to work with your designer one-on-one. (We do suggest making an appointment so that your designer can dedicate plenty of time with you. Of course, you are always welcome to drop-in as well.) The map you've created is simply a starting point. Once you decide to select products and reach a more detailed stage in design planning, your designer will come to your home to do a professional measure. This initial rough map will simply help your designer get a sense of your space so the more detailed work of creating your dream room can begin!

Your Carole's Designer: _____

Designer's e-mail address: _____

Designer's (Typical) Showroom Hours: _____

Woburn Showroom, 50+ displays & In-Stock Vanity Center
215 Salem St., Woburn 781.933.3339 781.938.7624 (fax)
Monday and Friday 9-5 Tuesdays, Wednesdays, and Thursdays 9-8 Saturdays 9-4
kitchenpeople.com

How to Create a Rough Map of Your Current Space

- Step 1: Measure the walls, doors, & windows.

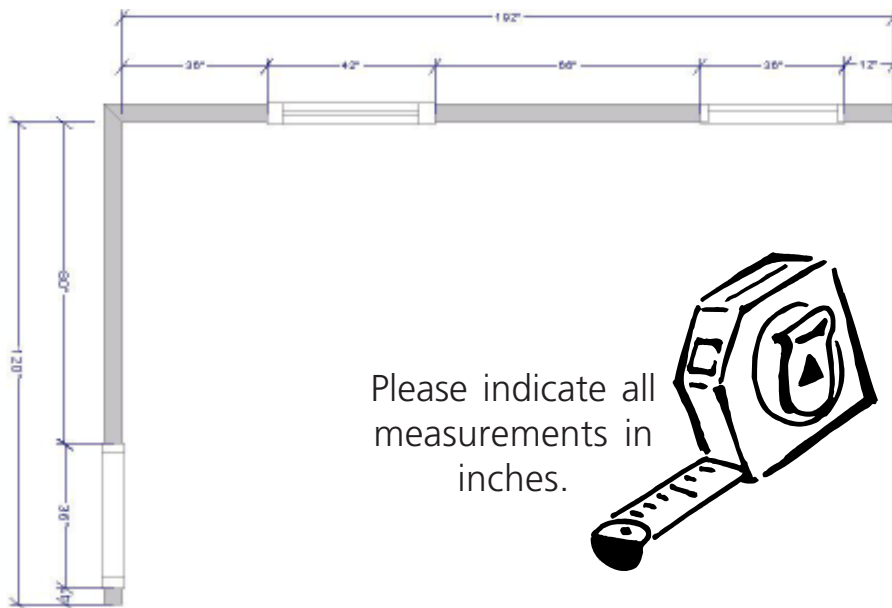

Please indicate all measurements in inches.

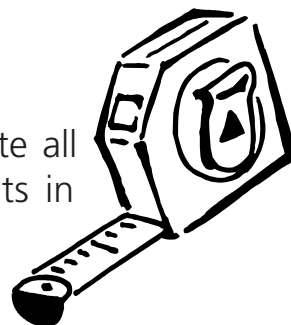

- Step 2: Add the locations and measurements for your appliances to your drawing.

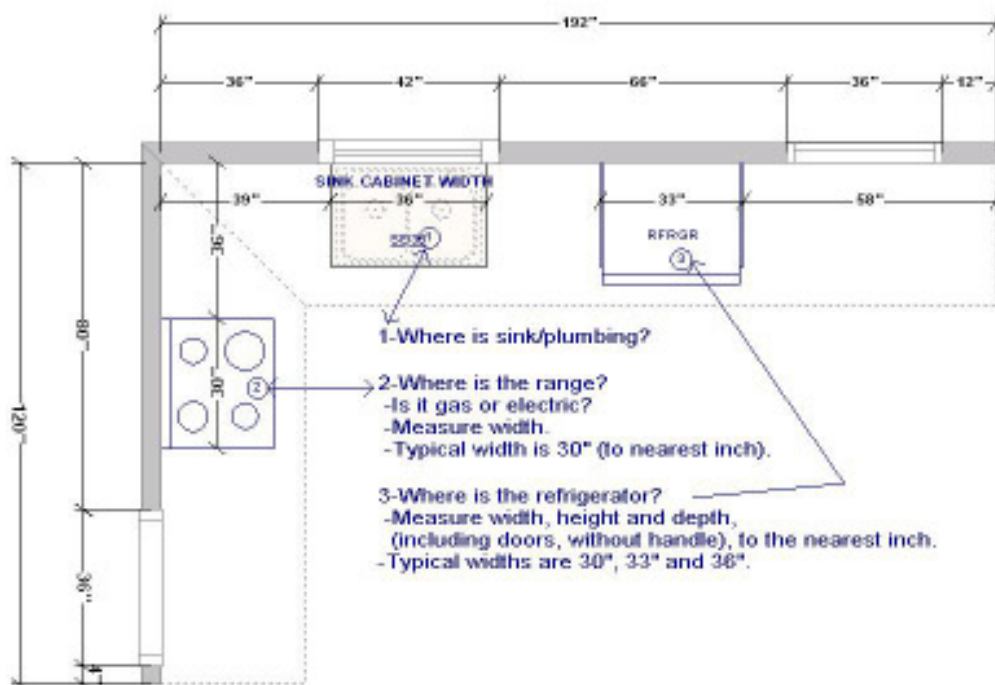

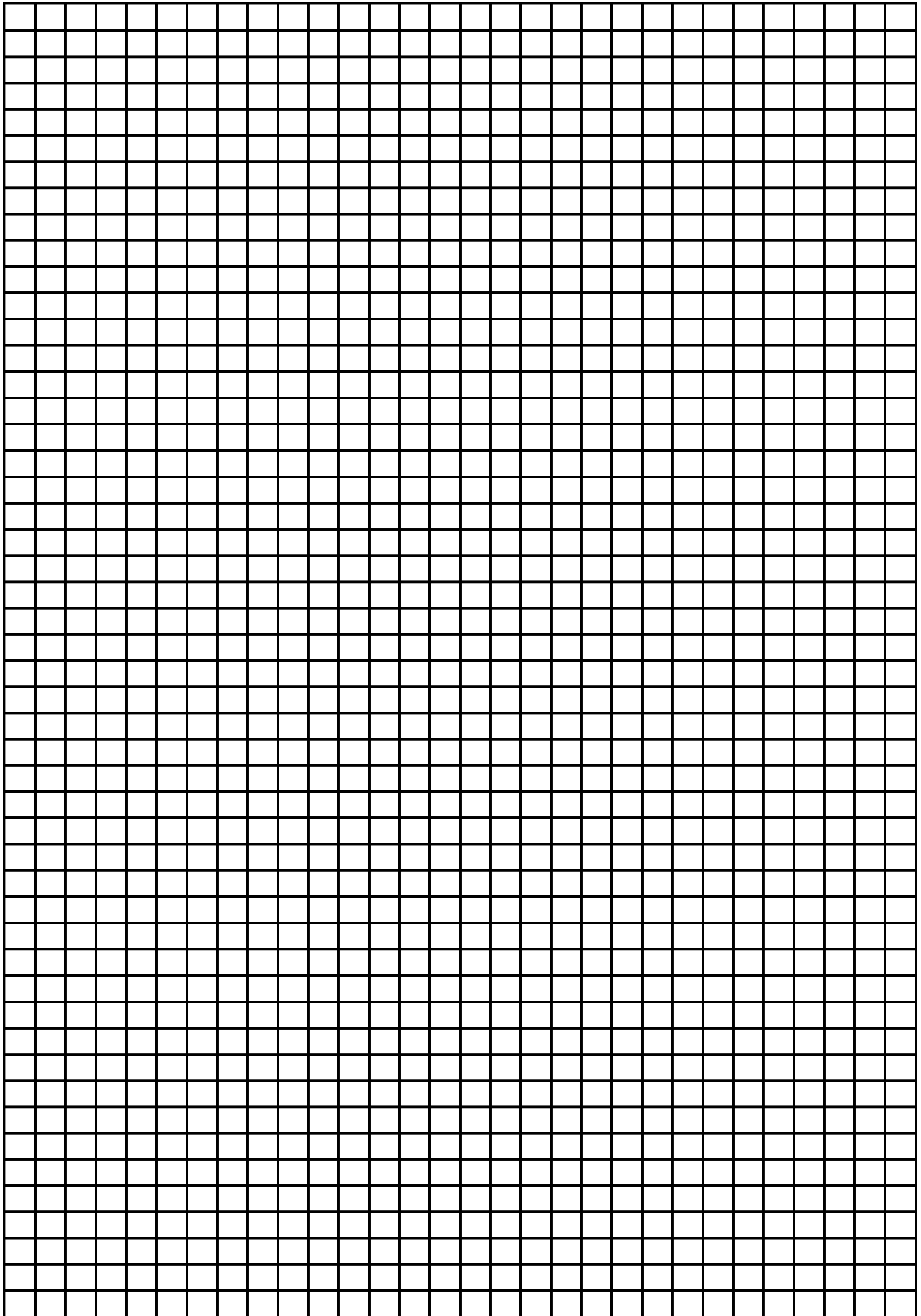

Please tell us about your current space.

My project involves (circle one): New Construction Remodeling

My project includes the following rooms: _____

The main complaints I have about my current space are:

Other comments: _____

Please tell us about your ideas/goals for your new-improved space.

I am interested in the following brands of cabinets, countertops, or appliances:

My main goals for my new space are: _____

My biggest concerns about this project are: _____

I'd describe my design style as (for instance, contemporary, country, traditional, etc.):

What I need most from my designer is: _____

My target budget for my project is: _____

I'd like my project to be completed by: _____

Other comments: _____



kitchenpeople.com

215 Salem St., Woburn 781.933.3339 781.938.7624 (fax)